

# PERIMETER

SURVEYING & MAPPING  
 Prepared by: Jeff S. Hodapp, P.S.M.  
 Certificate of Authorization No. LB7264  
 951 Broken Sound Parkway, Suite 108  
 Boca Raton, Florida 33487  
 Tel: (561) 241-9988  
 Fax: (561) 241-5182

A PORTION OF THE ORANGE POINT P.U.D.  
**WELLINGTON PRESERVE**  
 A PORTION OF SECTION 34, TOWNSHIP 44 SOUTH, RANGE 41, EAST,  
 VILLAGE OF WELLINGTON, PALM BEACH COUNTY, FLORIDA.  
**DECEMBER 2003**

181

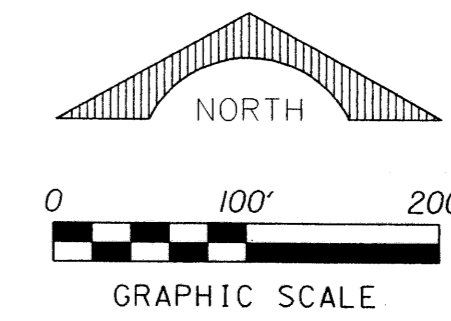

NORTHEAST CORNER  
 SECTION 34-44-41  
 FOUND BRASS DISK • 2297  
 IN CONC. MONUMENT  
 (FOUND PALM BEACH COUNTY  
 BRASS DISK IN CONC.  
 MONUMENT - 3.1' N. 1.8' E.)

UNPLATTED  
 SECTION 27-44-41

NORTH LINE SECTION 34-44-41



SHEET 2 OF 7

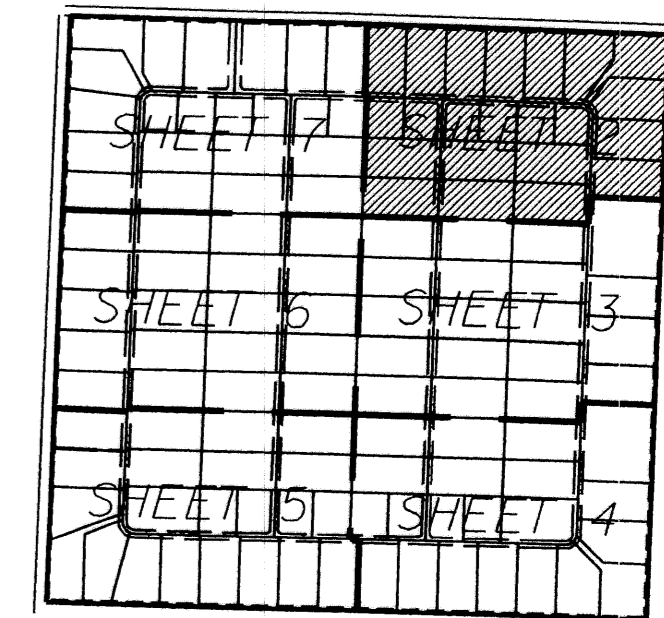

KEY MAP  
 NOT TO SCALE

"HOMELAND"  
 (P.B. 33 PGS. 111-117)

LEGEND:

- SET P.R.M. (UNLESS OTHERWISE NOTED) - ALUMINUM DISK IN 4"x4" CONC. MON. STAMPED LB7264
- P.C.P. CENTERLINE

ABBREVIATIONS:

- CH CHORD
- CHB CHORD BEARING
- CONC. CONCRETE
- COR. CORNER
- Δ DELTA (CENTRAL ANGLE)
- D.B. DEED BOOK
- D.E. DRAINAGE EASEMENT
- ARCLNGTH ARC LENGTH
- L.B. LICENSED BUSINESS
- L.M.E. LAKE MAINTENANCE EASEMENT
- L.A.E. LAKE ACCESS EASEMENT
- L.S. LICENSED SURVEYOR
- MON. MONUMENT
- O.R.B. OFFICIAL RECORDS BOOK
- N.R. NON-RADIAL
- P.B. PLAT BOOK
- P.B.C.R. PALM BEACH COUNTY RECORDS
- P.C. PAGE
- P.C.P. PERMANENT CONTROL POINT
- P.R.M. PERMANENT REFERENCE MONUMENT
- P.S.M. PROFESSIONAL SURVEYOR & MAPPER
- P.U.D. PLANNED UNIT DEVELOPMENT
- R. RADIUS
- R/W RIGHT-OF-WAY
- SEC. SECTION
- S.F. SQUARE FEET
- U.E. UTILITY EASEMENT

SEE SHEET 3